

MOUZA:- AHMADPUR. J.L. NO-154

P.S:- SAINTHIA. DIST- BIRBHUM.

SCALE. - 33'-0" = 1'

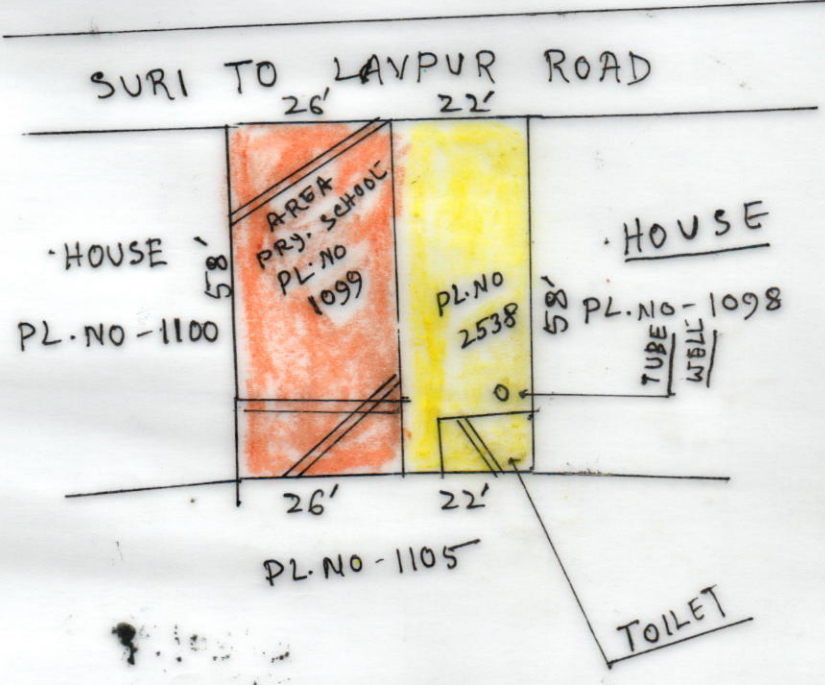

SCHEDULE
SCHOOL NAME:- AHAMADPUR GIRLS C.D.P.
DISE CODE:- 19080704402. SCHOOL
CIRCLE:- AHAMADPUR
BLOCK:- SAINTHIA
PANCHAYAT:- AHAMADPUR
MOUZA:- AHMADPUR
J.L. NO:- 154
PLOT NO:- 1099. 1099/2538
KHATI ANNO:- 1352
AREA OF LAND:- 2784 S. FT. OR .063 AC
USABLE AREA:- 1508 S. FT (PRY).
= 1276 S. FT (A)
FALLOW AREA:-

SIG. OF H.T

Purnima Chatterjee,  
 Head Teacher 29/05/15  
 Ahmadpur Girl's C.D.P. School  
 P.O:- Ahmadpur, Birbhum

DRAWN BY  
 GADADHAR PAL  
 20.05.2015

Surveyor  
 GADADHAR PAL  
 G. R. No. - S/68206  
 Vill.- Kusumjatra, Birbhum