

MOUZA - BANJITHA J.L. NO - 179
P.S - PANRUI DL - BIRBHUM.
SCALE - 33' = 1"

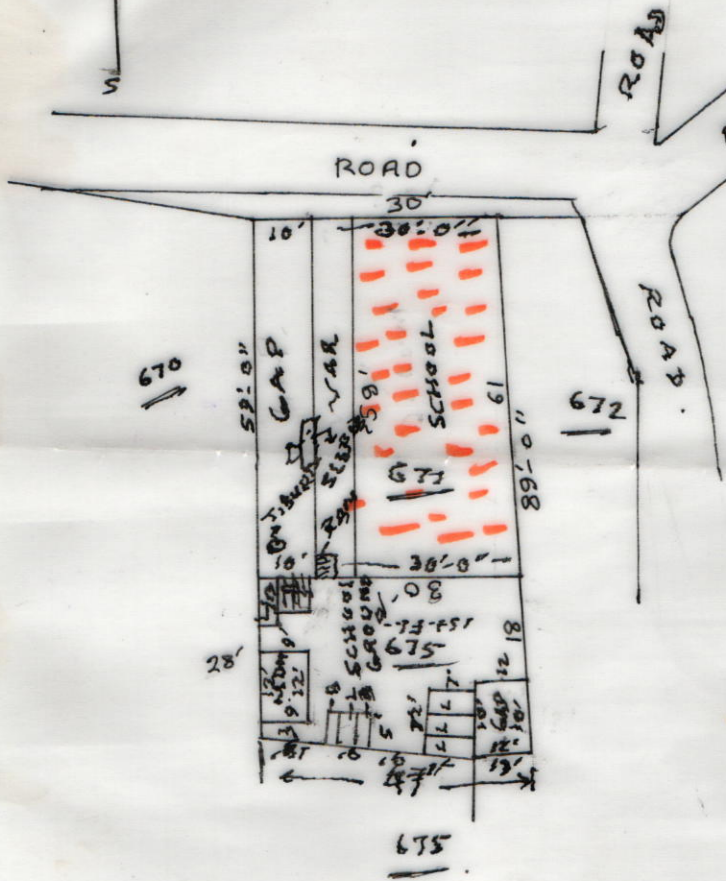

REFERENCE

1	SCHOOL NAME -	GARGARI C.B. SCHOOL
2	DISE CODE -	19080702003
3	CIRCLE -	AHAMEDPUR.
4	BLOCK -	SAINTHIA
5	PANCHAYET -	AMARPUR
6	MOUZA -	BANJITHA
7	J.L. NO -	179
8	PLOT NO -	671, 675
9	KHATIAN NO -	93
10	AREA OF LAND -	30492 SFT (3828 SFT)
11	OR -	- 07000 Records Act - 0879 ACRE
12	USEABLE AREA -	3118 SFT (0715 ACRE)
13	FALLOW AREA -	710 SFT (0163 ACRE)
14	AREA OF ANG. CENTER -	NIL
15	AREA OF UPPER PRY -	NIL

Prepared by - Ganerje
Amin.
23/05/2016.

Swojan Kumar Das.
 29.5.2015

TEACHER-IN-CHARGE
GARGARIA CONVERTED BASIC SCHOOL
GARGARIA, BIRBHUM