

GOPALPUR PRIMARY SCHOOL

Estd.-1-12-1958

Ahmadpur Circle ● Amarpur Gram Panchayet

P.O.-IKRA-HAZRAPUR, DIST.-BIRBHUM



Ref. No.

MOUZA:- GOPALPUR, J.L NO- 17
P.S:- PANRUI DT:- BIRBHUM

Date.....

SCALE: 1" = 33'

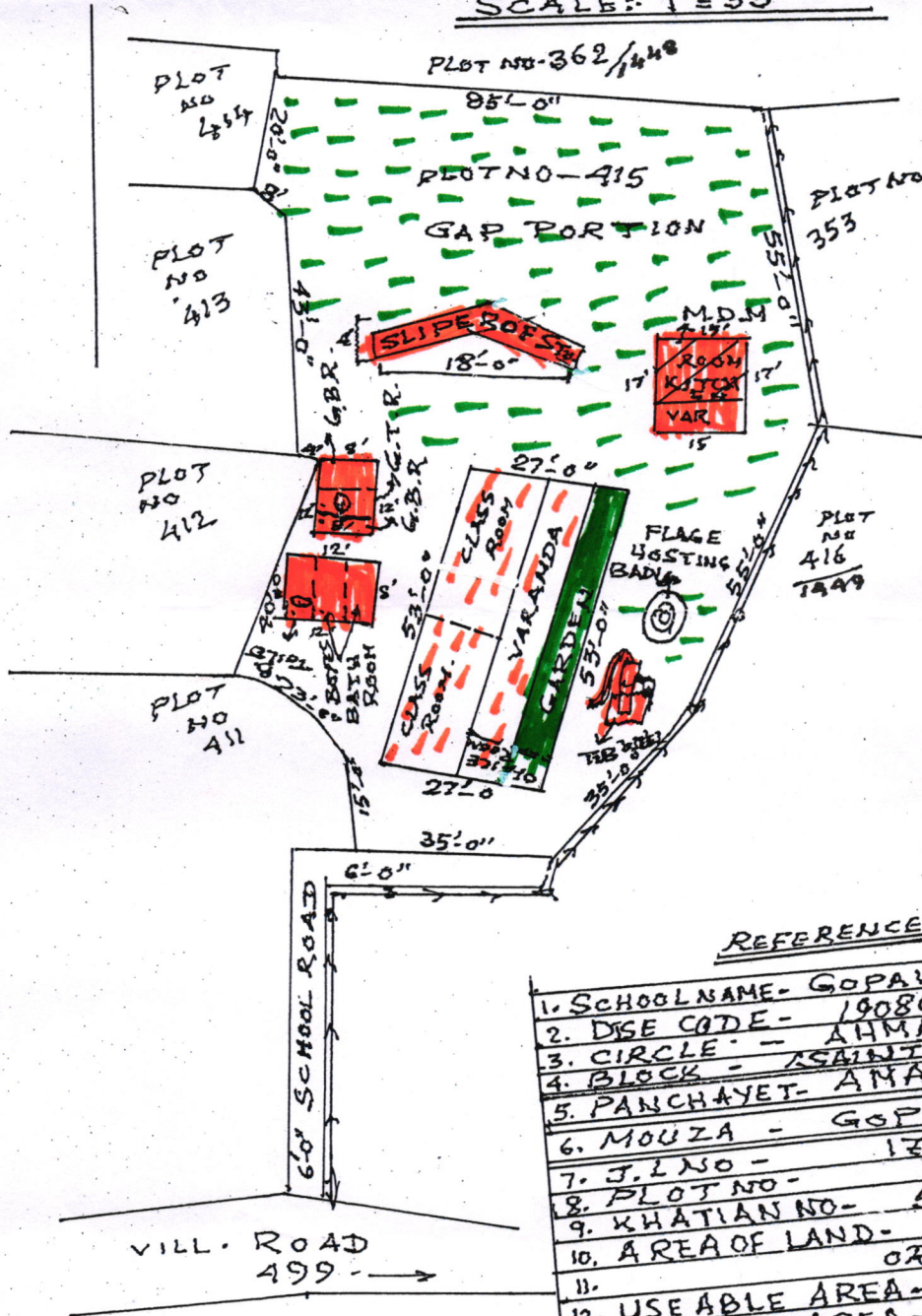

REFERENCE

1. SCHOOL NAME -	GOPALPUR PRY. SCHOOL
2. DISE CODE -	19080701504
3. CIRCLE -	AHMADPUR CIRCLE
4. BLOCK -	ASAINTHA
5. PANCHAYET -	ANARPUR GRAM PANCHAYET
6. MOUZA -	GOPALPUR
7. J.L NO -	178
8. PLOT NO -	415
9. KHATIAN NO -	51 (RS-184,185)
10. AREA OF LAND -	10890 SFT.
11.	OR- 0.2500 OF AN ACRE
12. USE ABLE AREA -	21654 OR 0.497 ACRE
13. FALLOW AREA -	87254 OR 2.003 ACRE
14. AREA OF ANG CENTER -	NIL
15. AREA OF OPDR PRY -	NIL

Prepared by - Amin
12-05-2016

Signature of the H.T.
18/05/2015

Head Teacher
Gopalpur Primary School
P.O. - Ikra-Hazrapur
Birbhum