

MOUZA - LAYEKPUR, J. L. NO - 58  
 P.S. - SAINTHIA, DIST - BIRBHUM  
 SCALE - 1" = 1mm

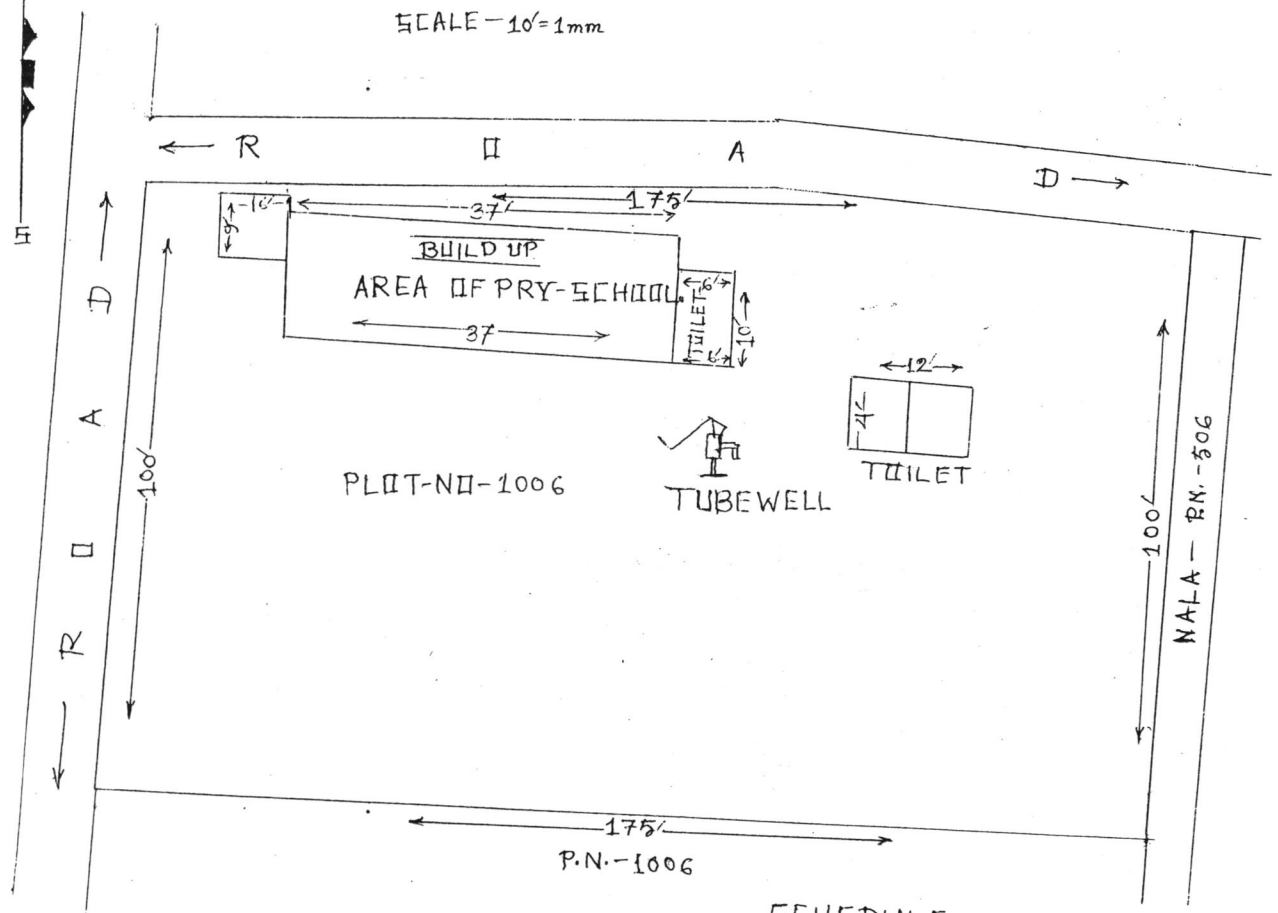

SCHEDULE

SCHOOL NAME - LAYEKPUR-PRY-SCHOOL
DISE-CODE - 19080701004
CIRCAL - AHMADPUR
BLOCK - SAINTHIA
PANCHAYAT - SANGRA
MOUZA - LAYEKPUR
J. L. NO - 58
PLOT-NO - 1006
KHATIAN-NO - 86
AREA - OF LAND - 17500 - S.FT
USEABLE AREA - 1288 - S.FT.
FALLOW AREA - 16212 - S.FT.

Sum by  
 Asim Kumar Mondal  
 24/05/2015

Prasanta Das  
 24/05/2015  
 Teacher-in-charge  
 Layekpur Primary School  
 Chhoto Sangra, Birbhumi

Asim Kumar Mondal  
 (Jt. Clear Server)  
 Chhoto Sangra, P.O. Niran.  
 Dist. Birbhumi