

MOUZA-MRITA DAS PUR. J.LNO-63.
P.S-SAINTHIA. DIST-BIRBHUM.
PLOT NO - 374/952.

SCALE - 1" = 33'

P.No-951.

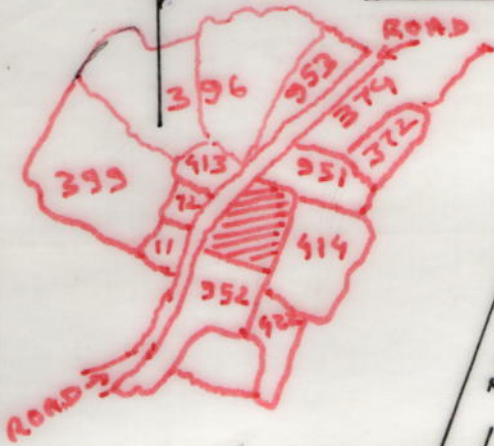

ACTUAL POSITION
OF THE PLOT
374/952

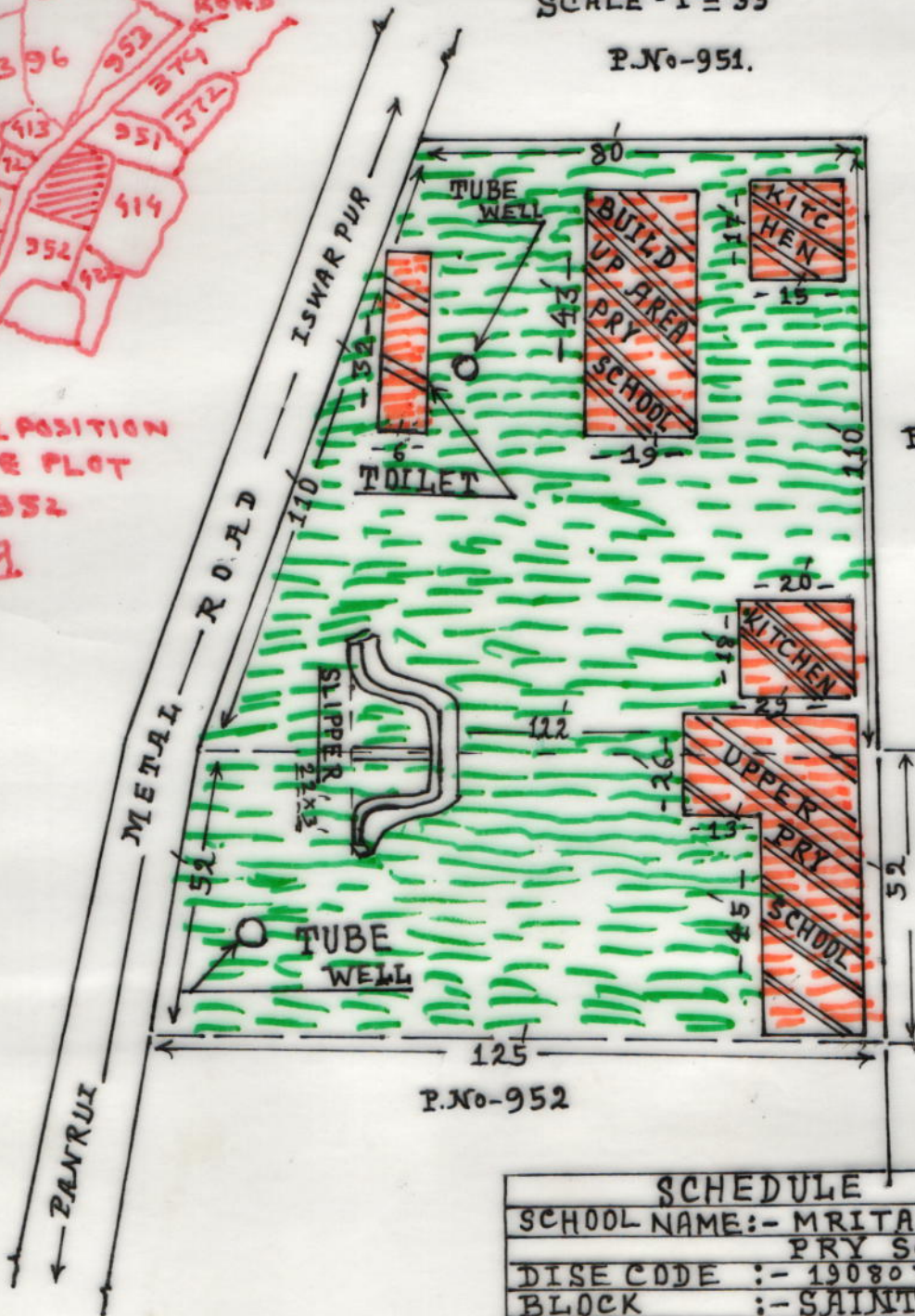

P.No-414.

P.No-952

SCHEDULE	
SCHOOL NAME:-	MRITADASPUR PRY SCHOOL.
DISE CODE :-	1908070093.
BLOCK :-	SAINTHIA.
PANCHAYAT:-	SANGRA.
MOUZA-	MRITADASPUR.
J.L No-	63.
KHATIAN NO:-	P.No-374/952
AREA OF LAND:-	17532 sqft / 0.40 Acre.
USABLE AREA:-	3236 sqft.
FALLOW AREA:-	14296 sqft.
AREA OF UPPER PRY SCHOOL	1474 sqft.
	+ 462 sqft = 1936 sqft.

SIG. OF H.T. / T.I.C

Debjit Chatterjee
27-03-15

374/952

बिर्भुम जिला,
संगरा पंचायत का: विभाग

Drawn by
Mihir Lal Mondal
Land Surveyor
23-05-2015

M. L. MONDAL
(Surveyor)

G. R. No.-S/68206/W.B/1733
Vill-P.O., Ahmadpur, Birbhum.