

MOUZA - DARPOSHILA, J.L. NO - 29
 P.S. -BOLPUR, DIST.-BIRBHUM. SCHOOL NO - 7

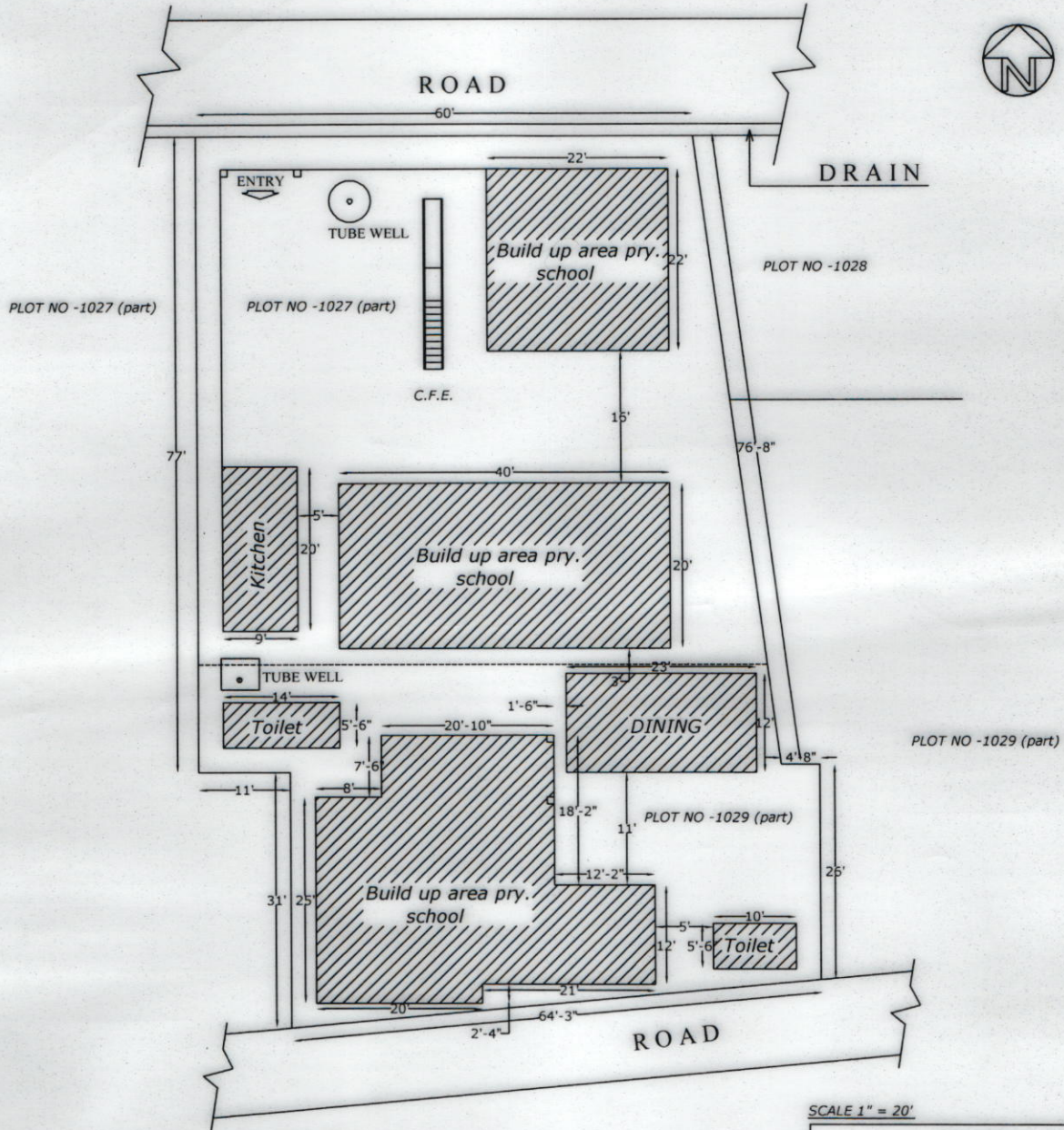

SCALE 1" = 20'

AREA STATEMENTS	
PLOT NO	AREA - Sq.Ft.
1027	4113
1029	2706
TOTAL	6819

SCHEDULE	
SCHOOL NAME -DARPOSHILA PRY. SCHOOL	
DISE CODE - 19080102701	
CIRCLE - BOLPUR INTENSIVE	
BLOCK - BOLPUR	
PANCHAYAT - Sarpalahana albandha gram panchyate	
MOUZA - DARPOSHILA	
J.L. NO - 29	
PLOT NO - 1027 (Part) & (1029 Part)	
KHATIAN NO - 96	
AREA OF THE LAND - 4113 Sq.Ft.	
USEABLE AREA - 2874 Sq.Ft.	
FALLOW AREA - 3945 Sq.Ft. (Fallow statments)	
AREA OF ANG.CENTRE -	
AREA OF UPPER PRY. -	

Baidyanath Saha
 Head Teacher
 Darposhila Panchayat School
 P.O.- Darposhila, Birbhum

Seal & sig. of H.T.

Pijus Mondal
Pijus Mondal
 (Surveyor)
 Reg. No. - S/6820/170

Sig. of amin

PRODUCED BY AN AUTODESK EDUCATIONAL PRODUCT

PRODUCED BY AN AUTODESK EDUCATIONAL PRODUCT