

MOUZA - NOWADANGAL, J.L. NO - 28
P.S. - BOLPUR, DIST.-BIRBHUM. SCHOOL NO - 6

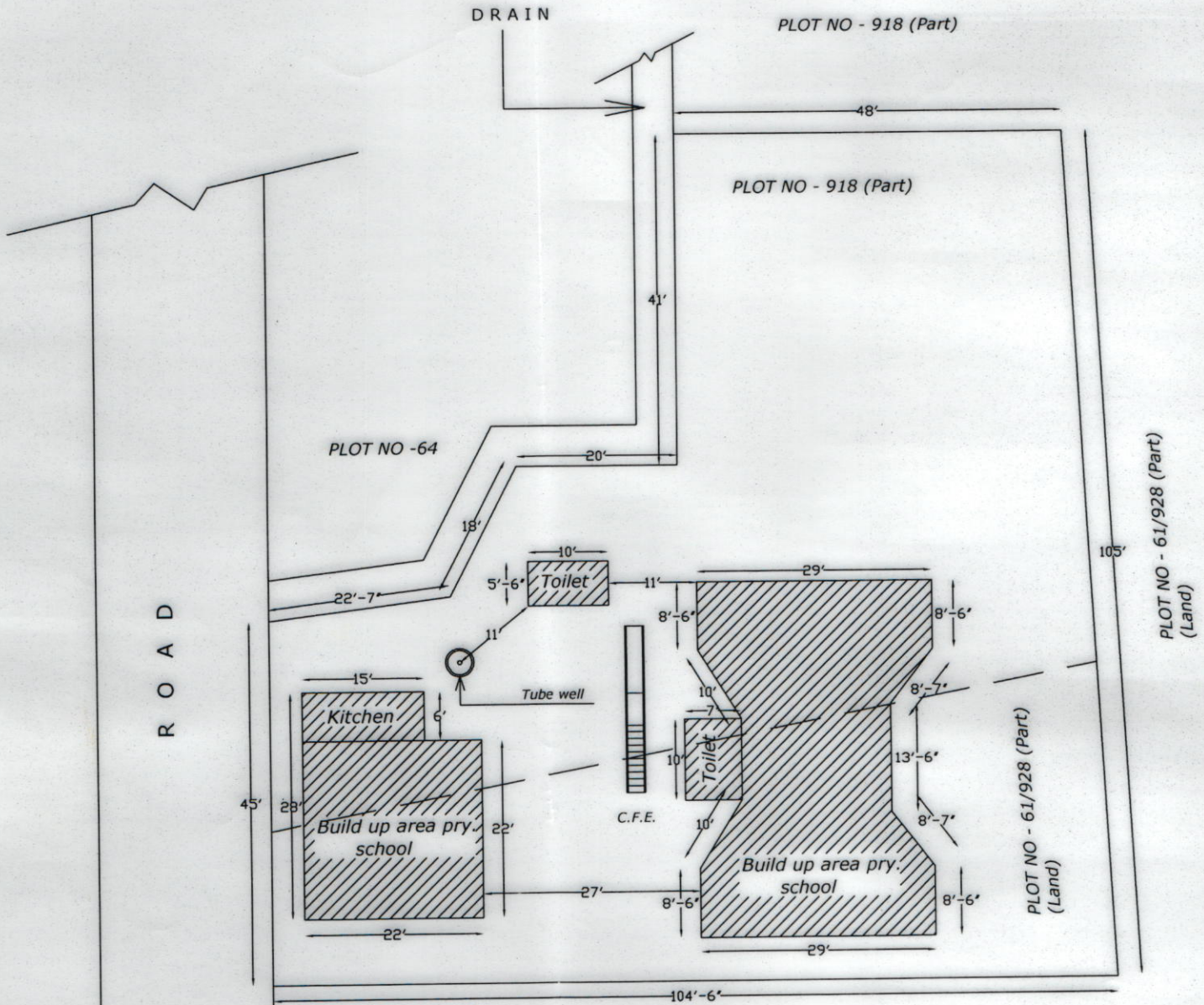

PLOT NO - 61/928 (Part)
(Land)

SCALE 1" = 20'

AREA STATEMENTS	
PLOT NO	AREA - Sq.Ft.
61/928	3008
64, 918	5109
TOTAL	8117

SCHEDULE	
SCHOOL NAME - NOWADANGAL PRY. SCHOOL	
DISE CODE - 19080102801	
CIRCLE - BOLPUR INTENSIVE	
BLOCK - BOLPUR	
PANCHAYAT - Sarpalahana albandha gram panchyate	
MOUZA - NOWADANGAL	
J.L. NO - 28	
PLOT NO - 61/928 (Part land)	
KHATIAN NO - 44	
AREA OF THE LAND - 3008 Sq.Ft.	
USEABLE AREA - 1771 Sq.Ft.	
FALLOW AREA - 6346 Sq.Ft. (Fallow statments)	
AREA OF ANG.CENTRE -	
AREA OF UPPER PRY. -	

Notar purnat Dalui
Teacher-in-Charge
Nowadangal Primary School
Village: Nowadangal, P.O. - Darpashila
Dist: Birbhum

Pijus Mondal
Pijus Mondal
(Surveyor)
Reg. No. - S/6820/17

Seal & sig. of H.T.

Sig. of amin