

MOUZA - PASCHIM BERUGRAM  
P.S. - BOLPUR, DIST - BIRBHUM

SCALE - 33'0" = 1"

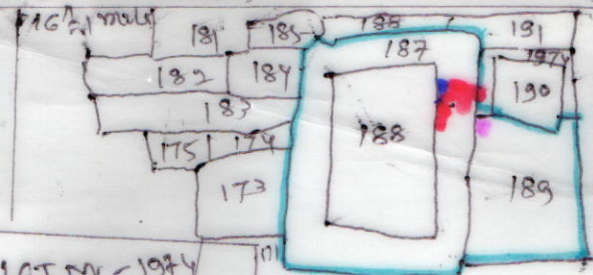

part of mouza map



- AREA OF LAND →
- SCHOOL BUILDING →
- TOILET →
- KITCHEN →
- TUBE WELL →

| SCHEDULE             |   |
|----------------------|---|
| SCHOOL NAME -        | SIMAIT J.B. SCHOOL  |
| DISE CODE -          | 19080105101   |
| CIRCLE -             | BOLPUR INTENSIVE  |
| BLOCK -              | BOLPUR SRINEKETAN   |
| PANCHAYAT -          | SIAM MULUCK GRAM PANCHAYAT  |
| MOUZA -              | PASCHIM BERUGRAM  |
| J.L. NO -            | 170   |
| PLOT NO -            | 187, 188, 189   |
| KHATA NO -           | I   |
| AREA OF LAND -       | PLOT NO - 187 - 191 D = 81457.2 SFT<br>PLOT NO - 188 - 116 D = 50529.6 SFT<br>PLOT NO - 189 - 108 D = 47044.8 SFT |
| USABLE AREA -        | 3589 SFT SCHOOL SFT.  |
| FALLOW AREA -        |   |
| AREA OF ANG CENTRE - |   |
| AREA OF UPPER PLY -  |   |

*[Signature]*  
18.05.15

Head Teacher  
SIMAIT J. B. SCHOOL  
Siam, Birbhum

Drawn by  
*[Signature]* Kunal Dam  
Surveyor: Siam, Birbhum  
Regis No - L / 21783  
Date: 18/05/2015