

MOUZA-BALLAVPUR ,J.L.NO-63,P.S-BOLPUR,DIST-BIRBHUM

SCALE: 8'-0"=1M

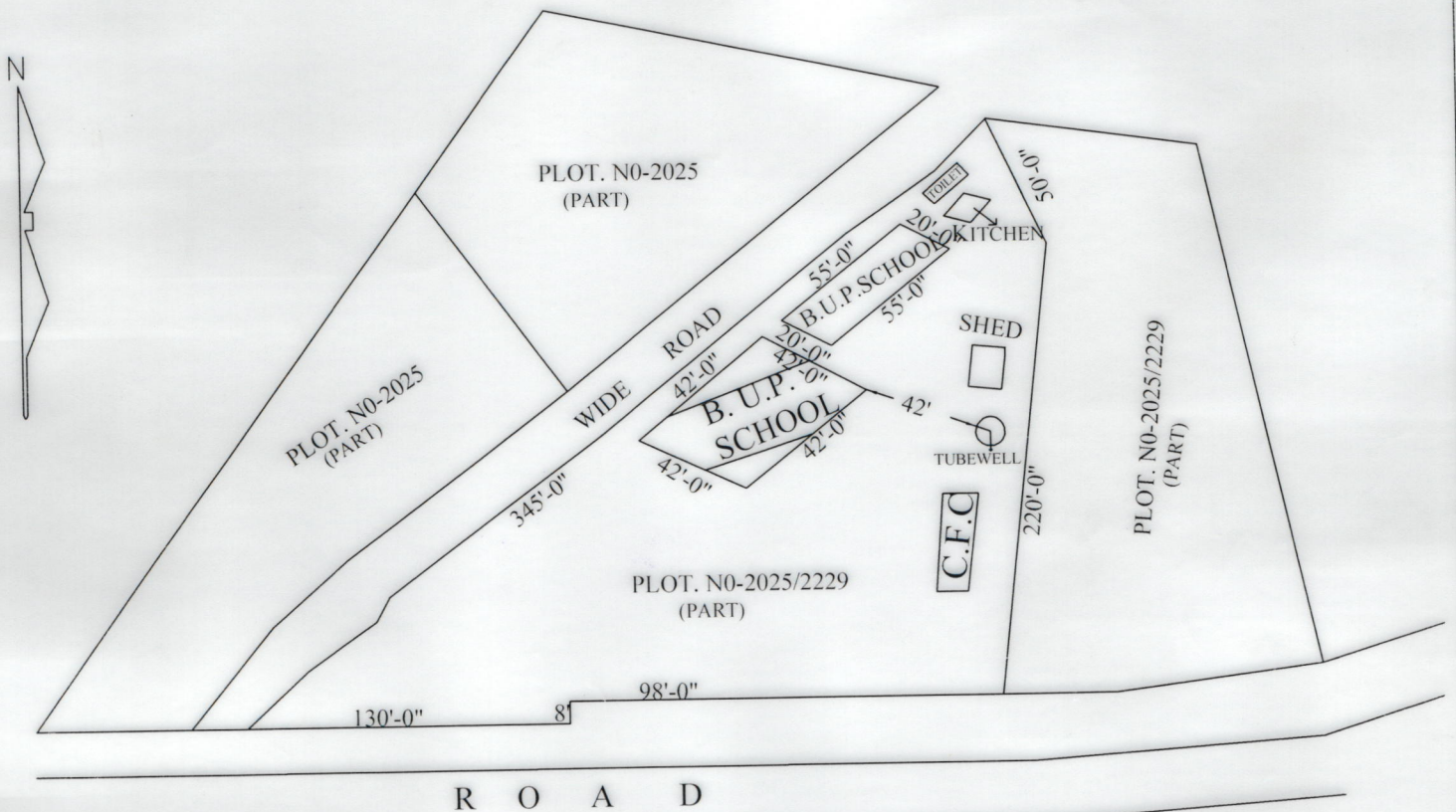

SCHEDUL

SCHOOL NAME:BALLAVPURDANGA PRY SCHOOL

DIST COODE :19080107104

CIRCLE:BOLPUR WEST

BLOCK: BOLPUR SRINIKETAN

PANCHAYET: RUPPUR G.P

MOUZA:BALLVBPUR

J.L.NO: 63

PLOT NO:2025 /2229 (PART)

L.R.KHATION NO:1

AREA OF LAND:43560 S.FT OR 01 ACRE

USABLE AREA:3054 S.FT

FALLOWER ARER: 700 S.FT

AREA OF UPPER PRY: 3054 S.FT



B. Mishra
27/05/15
Ballavpur Danga Panchayat School
Sriniketan, Birbhum

DRAWN BY
D. Saha
DEBASISH SAHA
(AMIN SURVEYOR)
GOVT. REGD. NO : 2556507001(W.B)
SONAJHURI PALLI, SANTINIKETAN
M:9233246932