

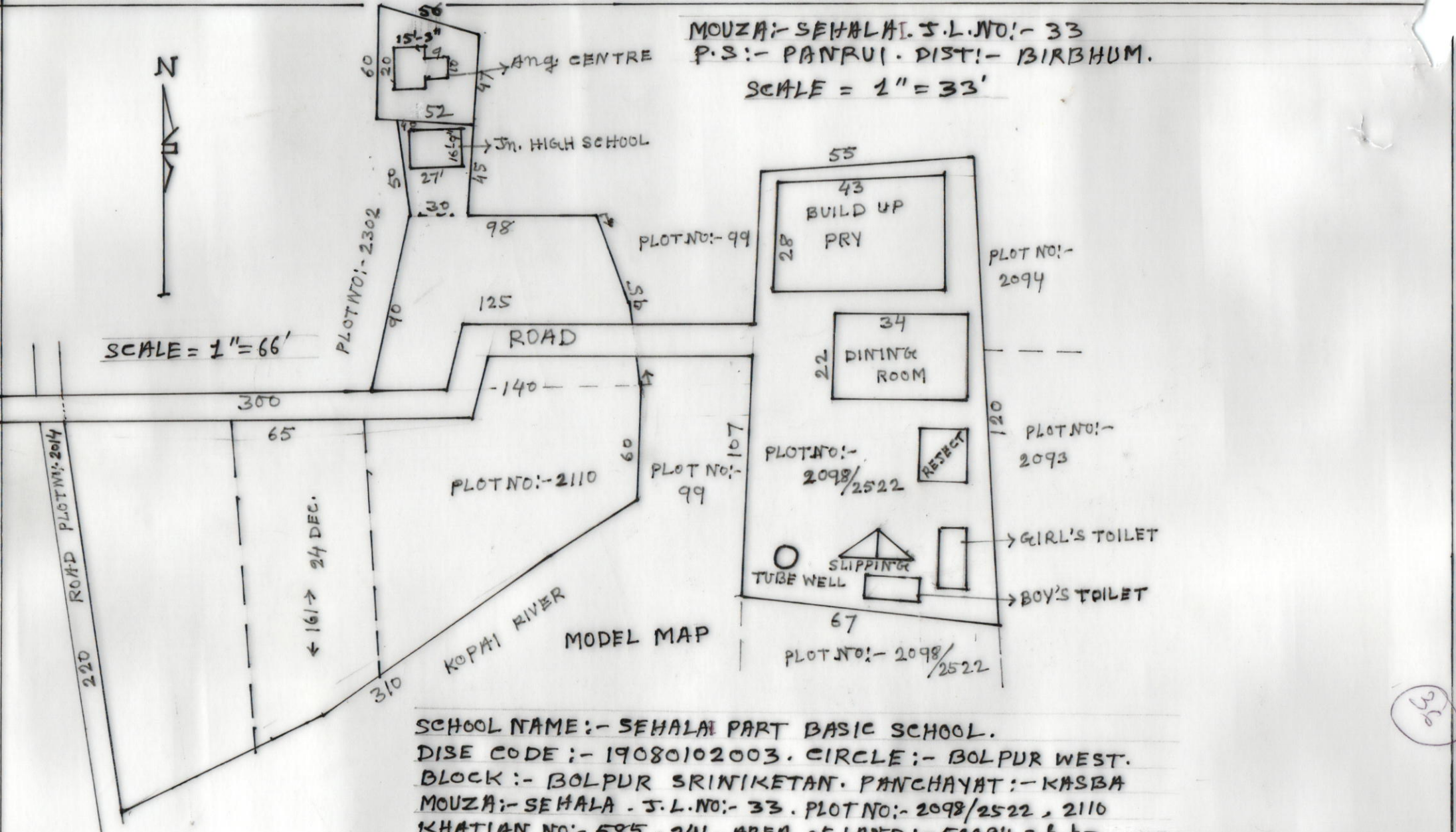

MOUZA:- SEHALA. S.L.NO:- 33
P.S:- PANRUI. DIST:- BIRBHUM.

SCALE = 1" = 33'

SCALE = 1" = 66'



SCHOOL NAME:- SEHALA PART BASIC SCHOOL.
DISE CODE:- 19080102003. CIRCLE:- BOLPUR WEST.
BLOCK:- BOLPUR SRINIKETAN. PANCHAYAT:- KASBA
MOUZA:- SEHALA. S.L.NO:- 33. PLOT NO:- 2098/2522, 2110
KHATAN NO:- 585, 241. AREA OF LAND:- 50094 s.f. = 1.1500 ACRE. USABLE AREA:- 1204 s.f. + PRY.
FALLOW AREA:- 48043 s.f. + AREA OF Jn. HIGH 452 s.f. +
AREA OF ANG. CENTRE:- 395 s.f. +

SEAL & SIG OF H.T.

Sandip Ghosh
TEACHER-IN-CHARGE
Sehala Part Basic School
P.O.- Darpashila, Dist.- Birbhum

DRAWN BY.
HARE KRISHNA PAL
Hare Krishna Pal
Surveyer
Babuiya, Birbhum
L. No.- 1551
22-05-2015

210