

MOUZA - BAHADURGANGJ - J.L :- 35

08

P.S. :- DUBRASPUR . DIST :- BIRBHUM

SCALE :- 33'0" = 1"

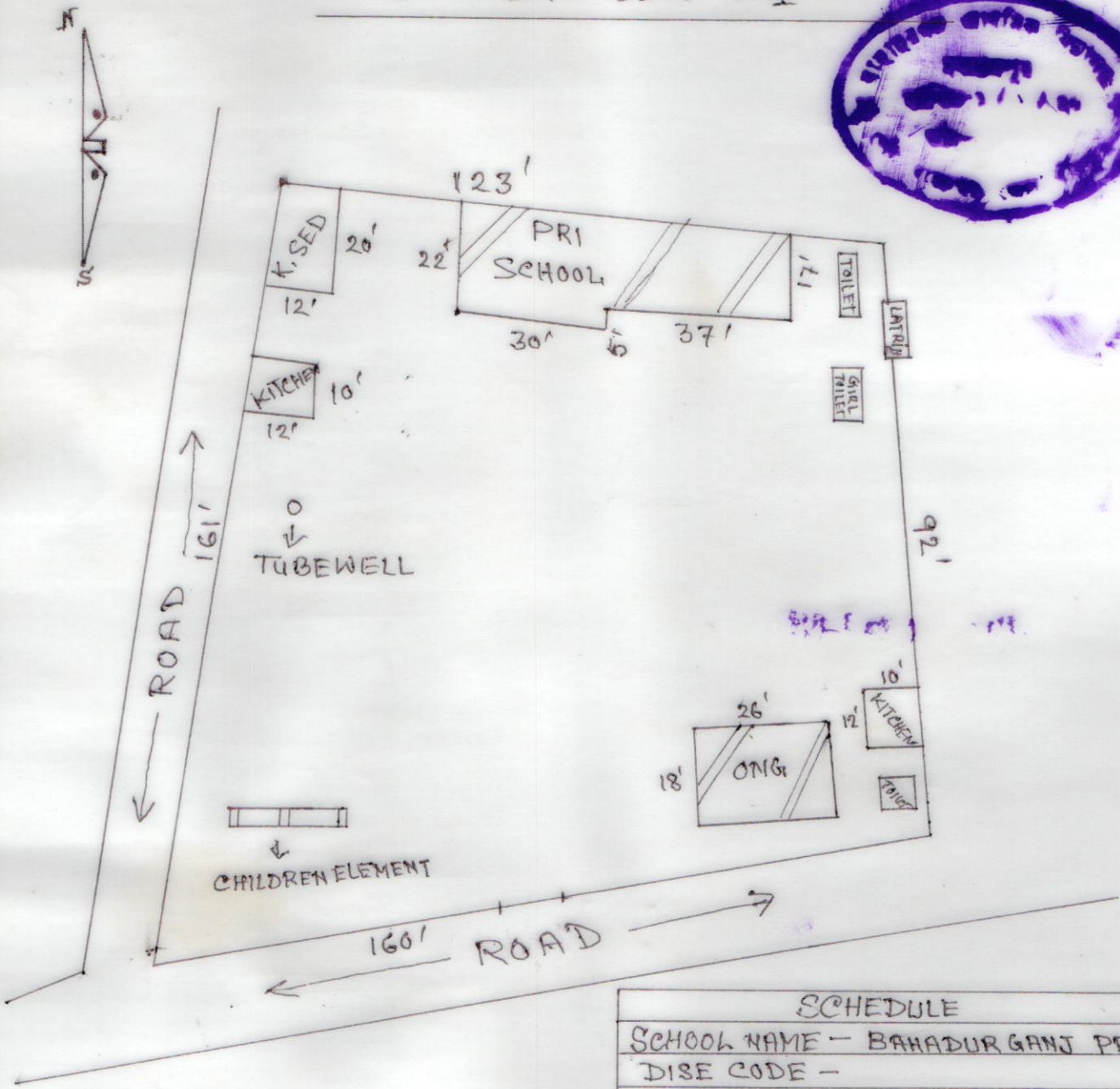

| SCHEDULE | |
|----------------|---------------------------|
| SCHOOL NAME - | BAHADURGANGJ PRI (D-VIII) |
| DISE CODE - | |
| CIRCLE - | DUBRASPUR |
| PANCHAYAT - | GOMALIARA |
| MOUZA - | BAHADURGANGJ |
| PLOT NO - | 615/915 |
| KHATIAN - | 106 |
| AREA OF LAND - | 17899 SFT = |
| USABLE AREA - | 2480 SFT. |
| FALLOW AREA - | 15419 SFT. |
| AREA OF ANGI - | 612 SFT. |

Sig. OF H.T.

Gadadhar Mandal -
Sig. OF AMIN

Basanti Kora 20.5.2015

GADADHAR NANDAI
SURVEYOR C.A. REGN. NO. 0748/96.