

MOUZA-BIDAIPUR, J.L NO-219, P.S -DUBRAJPUR,  
DIST- BIRBHUM.

SCALE 1"=33'

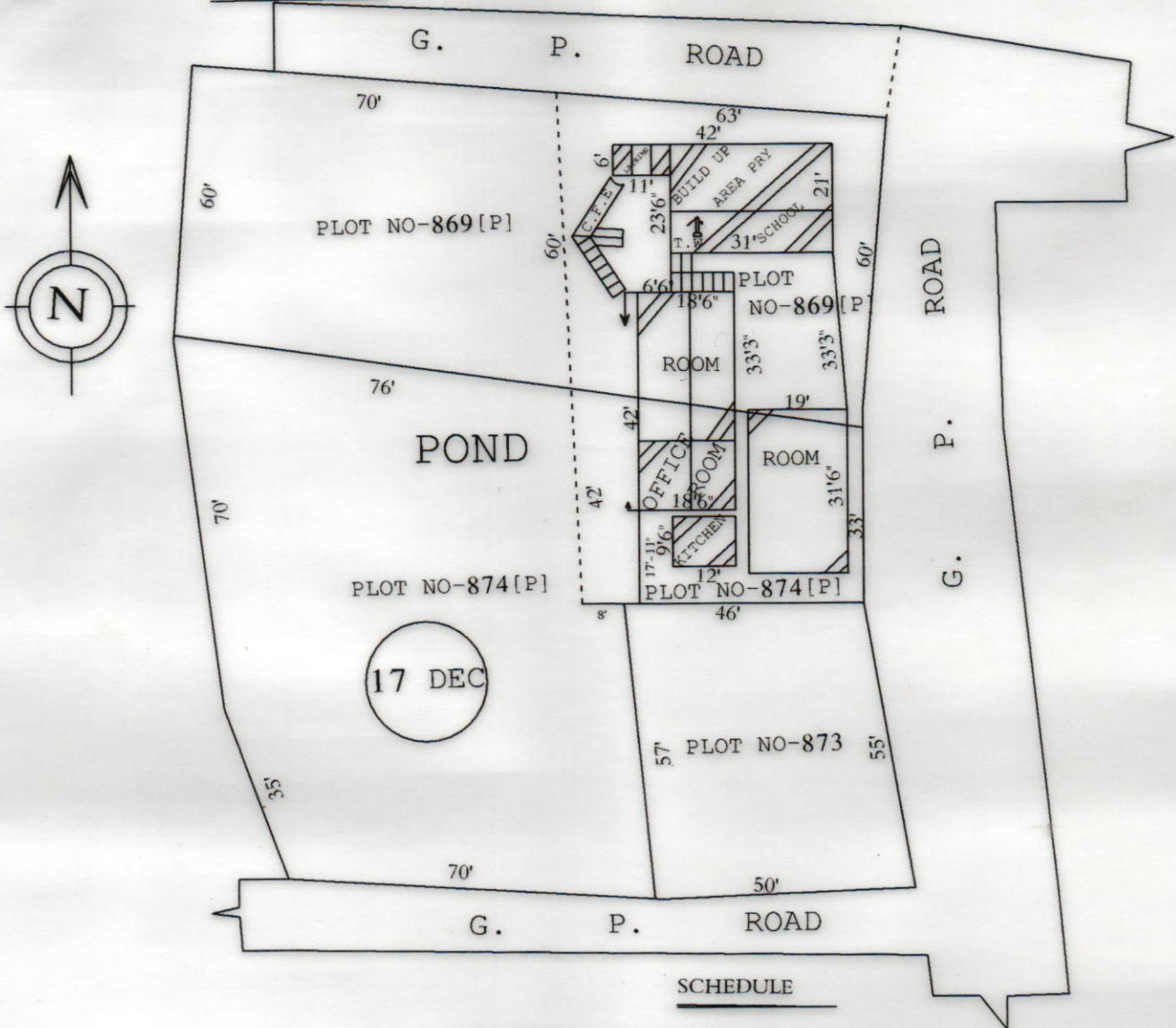

SCHEDULE

SCHOOL NAME:-BIDAIPUR PRY SCHOOL.

DISE CODE :-19081005904.

CIRCLE :-DUBRAJPUR SOUTH.

BLOCK:-DUBRAJPUR.

PANCHAYAT:- PADUMA.

MOUZA:-BIDAIPUR.

J.L NO:-219

PLOT NO :-869[P]-08 DEC.

PLOT NO :-874[P]-05 DEC.

KHATIAN NO :-133

AREA OF LAND:-5681 SFT.-0.13041 ACRE.

USABLE AREA - 2356 SFT.

FALLOW AREA- 3325 SFT.

AREA OF ANG.CENTAR - NIL.

AREA OF UPPER PRY -NIL.

Moheswar Ray 19.06.15  
SEAE & SIG. OF H.T.

Buddhader saw  
Signature of Amin 19.06.15

Head Teacher  
BIDAIPUR PRIMARY SCHOOL  
P.O.-Kandighi, Dist-Birbhum