

N

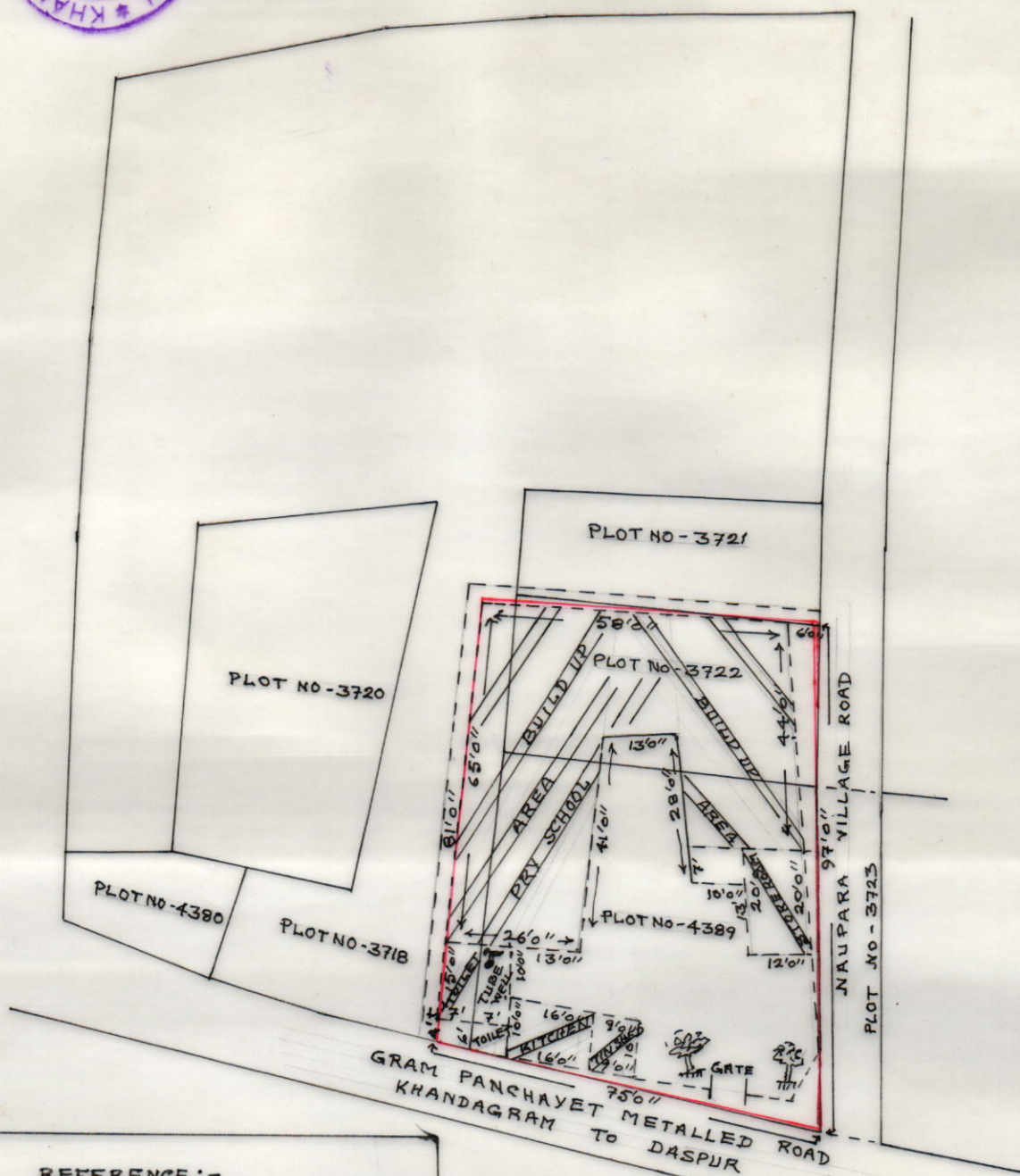

MOUZA :- KHANDAGRAM, J.L. NO-212  
P.S. - DUBRAJPUR, DIST. - BIRBHUM  
SCALE :- 33'0" = 1"



**REFERENCE :-**

L. R. PLOT BOUNDARY :- ( )

SCHOOL LAND BOUNDARY :- [Red Box]

SCHOOL NAME :- KHANDAGRAM PRY SCHOOL

DIST. CODE :-

CIRCLE :- DUBRAJPUR SOUTH

BLOCK :- DUBRAJPUR

PANCHAYET :- PADUMA

MOUZA :- KHANDAGRAM, J.L. NO-212

PLOT NO :- 4389, 3722, 3718 (PART)

KHATIAN NO :-

AREA OF LAND :- 6316 SFT. = 14.5 dec.

USABLE AREA :- 3267 SFT. = 7.50 dec.

AREA OF STORE ROOM, KITCHEN, TUBE WELL & TOILET :- 653 SFT. = 1.50 dec.

FALLOW AREA :- 2395 SFT. = 5.50 dec.

sk. Jyoti Mollah,  
Teacher-in-Charge  
Khandagram Pry. School  
Paduma IX V.E.C 17/06/15

Prepared by  
Mojibar Rahaman  
(Surveyor)  
G. R. No. - S / 68206  
Bharat Survey School  
Reg. by Govt. of W.B.  
VIII + P.O. - Khandagram, Birbhum