

MOUZA-NAMSAHAPUR, J.L NO-187,P.S
-SADAIPUR, DIST- BIRBHUM.

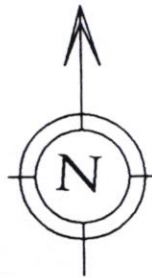
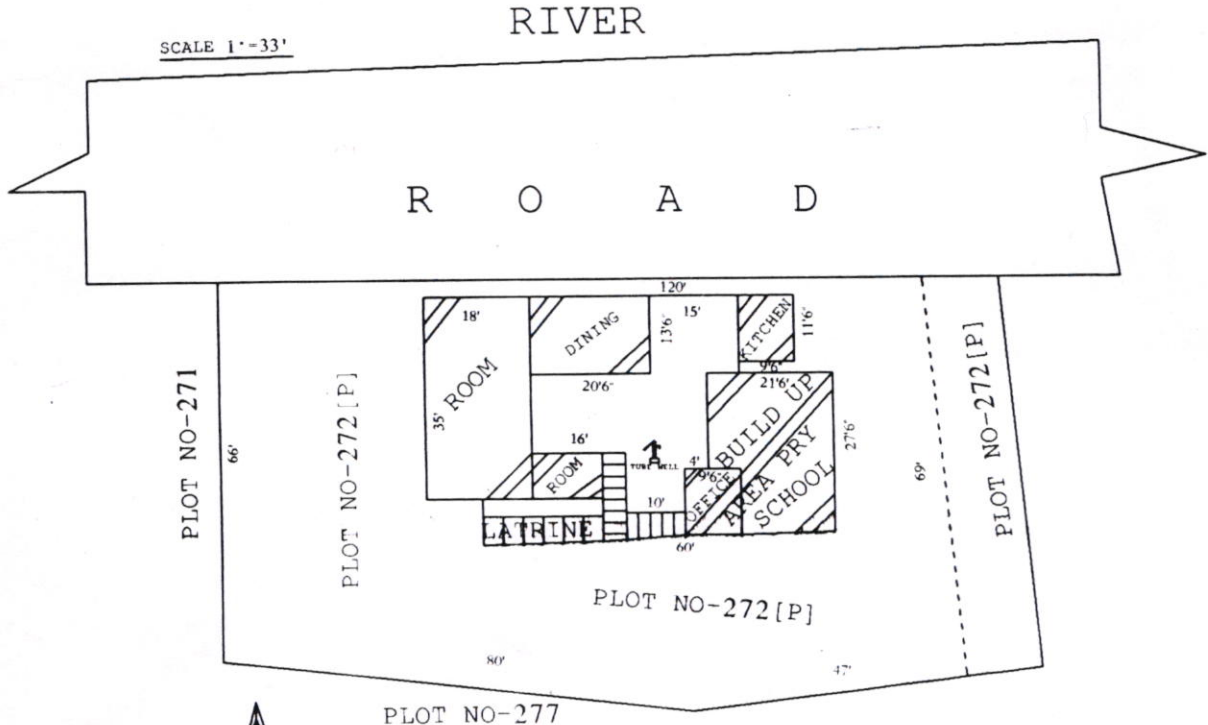

SCHEDULE

SCHOOL NAME:-RAMCHANDRAPUR PRY. SCHOOL.

DISE CODE :-19081012002.

CIRCLE :-DUBRAJPUR SOUTH.

BLOCK:-DUBRAJPUR.

PANCHAYAT:- SAHAPUR.

MOUZA:-NAMSAHAPUR.

PLOT NO :-272[P].

J.L NO:-187

KHATIAN NO :-13

AREA OF LAND:-8712 SQ.FT.-0.20 ACRE.

USABLE AREA -2105 SQ.FT.

FALLOW AREA- 6607 SQ.FT.

AREA OF ANG.CENTAR- NIL .

AREA OF UPPER PRY -NIL.

SELE & SIG. OF H.T.

Glush

Heau eacher
Ramchandrapur Primary schoer
Post & an Dist Birbhun

Buddhadev SOW
Signature of Amin

Surveyor

Buddhadev SOW
Vill.- Darampur, P.O.-
P.S.- Illambazar, Dist
Govt. Regd. No.- 6038175

28.05.15