

MOUZA-SEKENDARPUR, J.L NO-218,P.S  
 -DUBRAJPUR, DIST- BIRBHUM.PLOT NO-493  
 RECORD AREA 33 DEC.494 AREA-06 DEC.

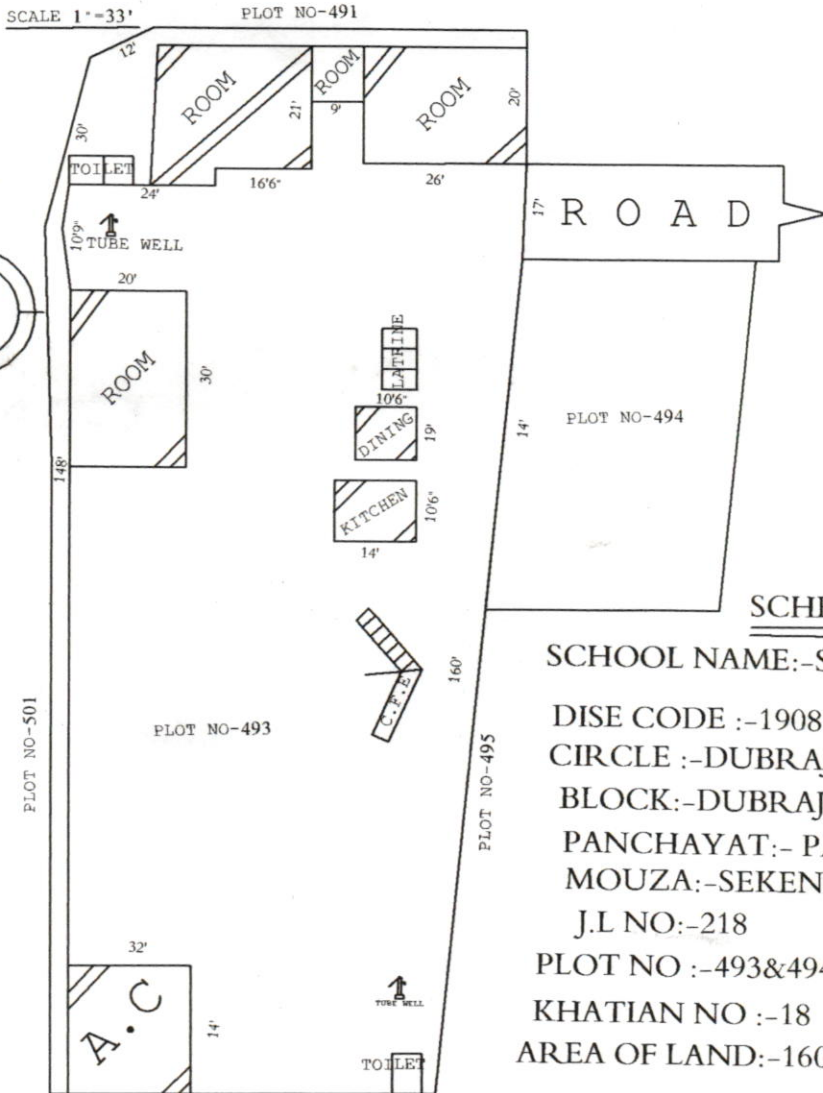

SCHEDULE

SCHOOL NAME:-SEKENDARPUR PRY. SCHOOL.

DISE CODE :-19081006004.

CIRCLE :-DUBRAJPUR SOUTH.

BLOCK:-DUBRAJPUR.

PANCHAYAT:- PADUMA.

MOUZA:-SEKENDARPUR.

J.L NO:-218

PLOT NO :-493&494.

KHATIAN NO :-18

AREA OF LAND:-16014 SFT.=0.36763 ACRE.

USABLE AREA -2675 SQ.FT.

FALLOW AREA- 13339 SQ.FT.

AREA OF ANG.CENTAR- 517 SQ.FT.

AREA OF UPPER PRY -NIL.

*Bimal Kumar Chatterjee*

SELE & SIG. OF H.T.

**Head Teacher**  
 Sekendarpur Primary School  
 P.O.-Jatra, Dist.-Birbhum

*28/05/2015*

*Buddhadev Sow*  
 Signature of Amin 28.05.15

**Buddhadev Sow**  
 Vill.- Darampur, P.O.- Sunmuni  
 P.S.- Illambazar, Dt.- Birbhum  
 Govt. Regd No.-65381/20137