

MOUZA - BHARATPUR. J.L. NO-79
 P.S - ILLAMBAZAR, DIST - BIRBHUM
 SCALE = 160" = 1 MILE

POND
 PLOT NO - 1904

PLOT NO - 1904/2747

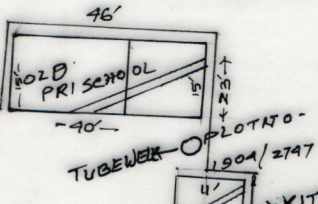

PLOT NO - 1901

PLOT NO - 1903

PLOT NO - 1873

PLOT NO - 1872

PLOT NO - 1874

PLOT NO - 1873

PLOT NO - 1876

PLOT NO - 1871

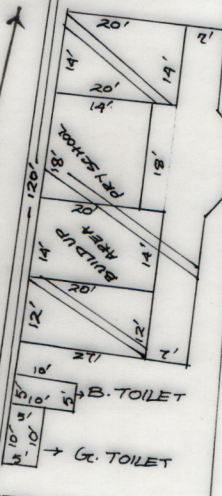

TUBEWELL

C.F.E.

PANCHAYET ROAD
 PLOT NO - 1828

PLOT NO - 1871

PLOT NO - 1870

SCHEDULE
 SCHOOL NAME - BHARATPUR SANWAL PALLI PRIMARY
 SCHOOL
 DISTRICT CODE NO - 19080209205
 CIRCLE - ILLAMBAZAR
 BLOCK - ILLAMBAZAR
 PANCHAYET - GHURISHA
 MOUZA - BHARATPUR. J.L. NO - 79. KH. NO - 5. 586
 PLOT NO - 1871, 1904/2747, 1872, 1873, 1874
 AREA LAND - 16, 62.9, 8.9 = 104 DECIMAL
 USABLE AREA - 3556 SFT
 FALLOW AREA - 16552 SFT

DRAWN BY
 Makhani Barui
MAKHAN BARUI
 (Surveyor)
 Regd. No. 833
 VIII Deshpur, P O Payer
 Dist: Birbhum

