

DIST:- BIRBHUM. P.S. ILLAMBAZAR.

MOUZA:- ICHAPUR. (PART-2) J.L.NO - 82.

SCALE - 80' = 1 CM

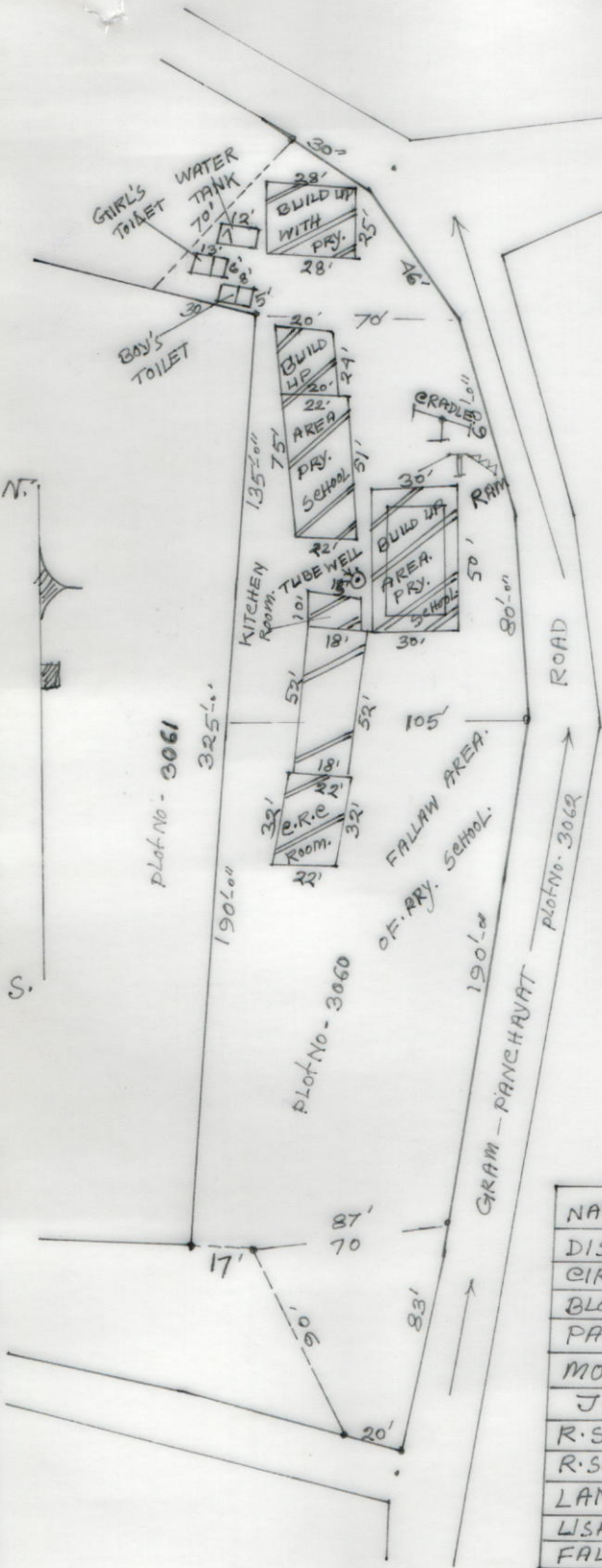

SCHEDULE.

NAME OF SCHOOL:- GHURISHA R.B.J.B. SCHOOL.
DISE CODE NO:- 19080208603
CIRCLE NAME:- ILLAMBAZAR.
BLOCK NAME:- ILLAMBAZAR.
PANCHAYAT NAME:- GHURISHA GRAM. PANEHAYAT.
MOUZA NAME:- ICHAPUR. (PART-2)
J.L.NO:- 82
R.S. PLOT NO:- 3060
R.S. KHATIAN NO:- 696/2
LAND OF AREA:- 13560 sq feet = 100 SATAK.
USABLE AREA:- 5220.0059 sq feet = 12 SATAK.
FALLAW AREA:- 37631.00 sq feet = 86.39 SATAK.
E.R.E. AREA:- 704.0059 sq feet = 1.61 SATAK.

SING. OF. H.T.

[Signature]
 8.6.2015
 Head Teacher
 Ghurisha R.B.J.B. School
 P.O. - Ghurisha, Dt. - Birbhum

SING. OF. AMINT.

[Signature] 7.6.15
 NAIM UDDIN MONDAL
 (Surveyor)
 Govt. Regd No-(S) 68206/0060
 Baruipur, Illambazar, Birbhum