

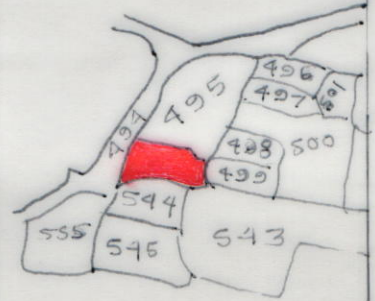

MOUJA- SALDANGA
 J.L. NO- 118.
 THANA- ILLAMBAZAR.
 DIST- BIRBHUM
 PLOT NO- 495. AREA- 20 SATAK.
 SCALE = 1" = 33'

MOUJA MAP



SALDANGA.

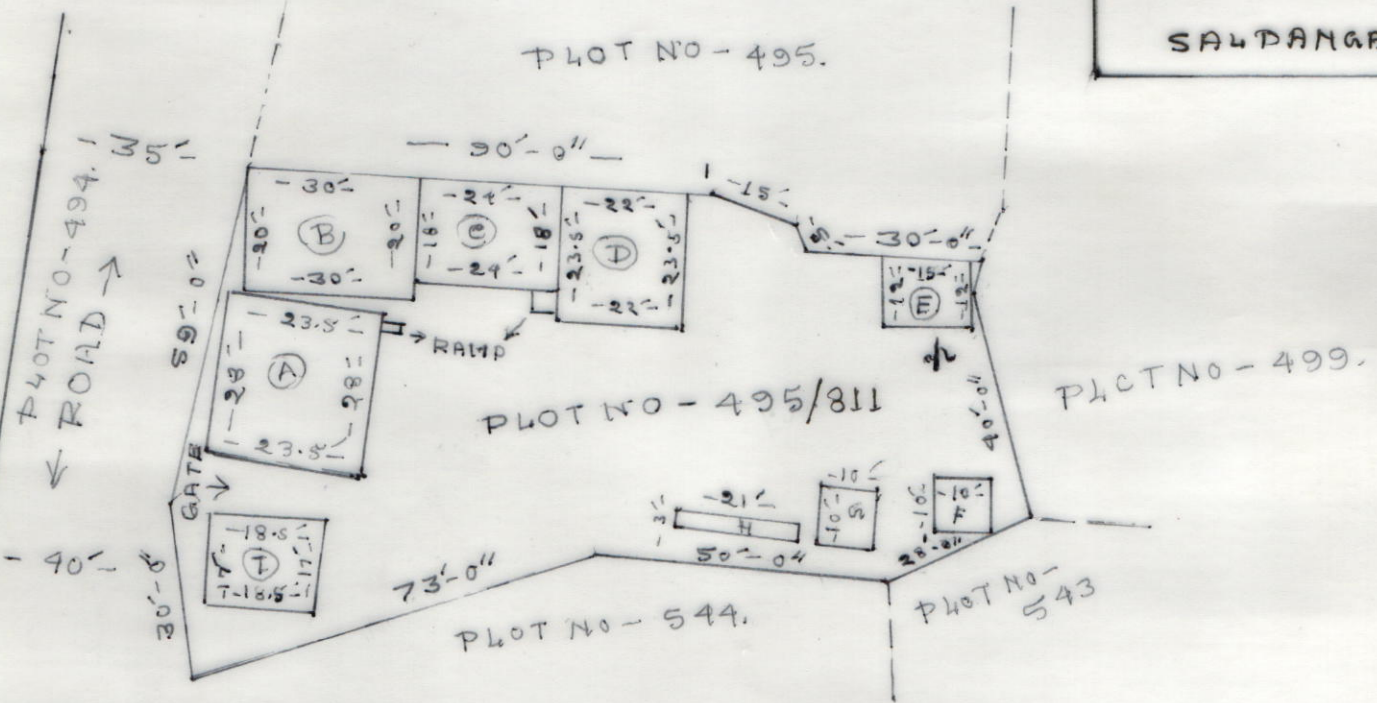

- N.B →
- (A) - A.C.R.
 - (B) - CLASSROOM
 - (C) - SHEED
 - (D) - A.C.R
 - (E) - KITCHEN SHEED.
 - (F) - G. TOILET.
 - (G) - B. TOILET.
 - (H) - C.F.E
 - (I) - OTHERS ROOM.
 - ♣ - TUBE WELL.

SCHEDULE

Name of school - SALDANGA PRY. SCHOOL.
 DISTRICT CODE - 19080203003.
 CIRCLE - ILLAMBAZAR NEW.
 BLOCK - ILLAMBAZAR.
 PANCHYET - BILATI.
 J.L. NO - 118.
 PLOT NO - 495/811.
 KHATAIN NO - 128.
 AREA OF LAND - 20 SATAKOR 87129 sqft
 USABLE AREA - 2965 sqft.
 FREE AREA - 5747 sqft.

Parimal Das
 H.T./T.I.C./AT 14.5.75.

Saldanga Primary School
 Saldanga, Dhalia, Birbhum

SEAL OF H.T./T.I.C

Panchanan Lohar

Lohar. 13/5/75 Amin F
 Govt. Regd. No. S/41248

S/O P. O. Ruppur Dist. Birbhum

SIGN OF P. AMIN